

KONA





Live a vibrant life.

There's a vibrant feeling about the new Kona. It's a youthful, playful design that stirs the senses and invites closer examination of its capabilities. Step inside, press the start button and Kona stirs to life to deliver exceptional dynamic performance. From front to back, Kona has been extensively enhanced to meet the needs of customers who lead active lifestyles.

Your style, your way.

The new Kona has a confident, modern style that has a way of always fitting in anywhere your travels may take you. Whether you're on a downtown dinner date or driving down a country road, Kona makes you feel perfectly at home.





Designed to be different.

Kona's powerful lines grab your attention from any angle. The design is strong and stable is reinforced at every turn including the armor-like cladding over the wheel arches. Extending into the rocker panels and both bumpers, this lower body cladding provides practical protection against stones and other road debris.



Style it to define your drive.

One look and you can tell that the new Kona is slightly ahead of its time. Futuristic? Definitely but there's nothing too radical about it: It's design innovation done just right. The geometry is sophisticated with plenty of interesting high-tech details like the LED lighting technology and the catchy-looking alloy wheels to delight and fascinate the eye.

Newly sculpted front end projects a sporty, muscular look



LED positioning lamps and LED DRLs



18" alloy wheels



LED rear combination lamps





An interior unlike any other.

Life is just so much easier with Kona. It offers plenty of cabin space to keep everyone comfortable and ample amounts of storage space. For added versatility, Kona's 60:40-split back seats can be folded down to make room for just about any type of cargo. Kona's generous dimensions extend to its new 10.25-in instrument panel and AVN unit.

10.25" LCD cluster

Wireless smartphone charging system



10.25" LCD touchscreen



60:40 split-folding rear seat







An impressive performance.

From the moment you step on the accelerator to unleash Kona's full potential, you will be smiling at the surge of quiet, clean power. Kona's power plants are third generation which means they benefit from the very latest technologies that improve their efficiency, reliability and, most importantly, your driving enjoyment. You have three engines to choose from and pure driving pleasure has been engineered into each one.

Smartstream G1.6 T-GDi	Smartstream G2.0 Atkinson	Smartstream G1.0 T-GDi
198 Maximum Power ps/6,000 rpm	149 Maximum Power ps/6,200 rpm	120 Maximum Power ps/6,000 rpm
27.0 Maximum Torque kg-m/1,600-4,500 rpm	18.3 Maximum Torque kg-m/4,500 rpm	17.5 Maximum Torque kg-m/1,500-4,000 rpm



Bring your sense of adventure.

Kona's advanced control systems give you the confidence to drive down less travelled roads or in poor weather conditions. The large jog wheel on the center console provides access to Kona's advanced electronic control systems : This jog wheel may look simple but it offers powerful features: With a quick turn and a click, Kona keeps you going, exploring and discovering.



Drive Mode

The Drive Mode selector offers a choice of three different settings to suit your personal preferences. Drive Mode automatically modifies the gear shift schedule to transform Kona's personality into frugal, fast or just plain normal.



ECO

ECO Mode

While gas mileage on the new Kona is already impressive, driving in Eco Mode is guaranteed to save you money at the fuel pump.



SPORT

SPORT Mode

Sport Mode is made for those times when you just feel like letting it go. With Sports Mode dialed in, Kona responds with energetic enthusiasm, the pace quickens and the fun begins.



NORMAL

NORMAL Mode

Normal is a happy place to be as it puts you at the half-way point between Eco and Sport. Offering the best of both, this setting delivers perfectly relaxed, everyday driving performance.

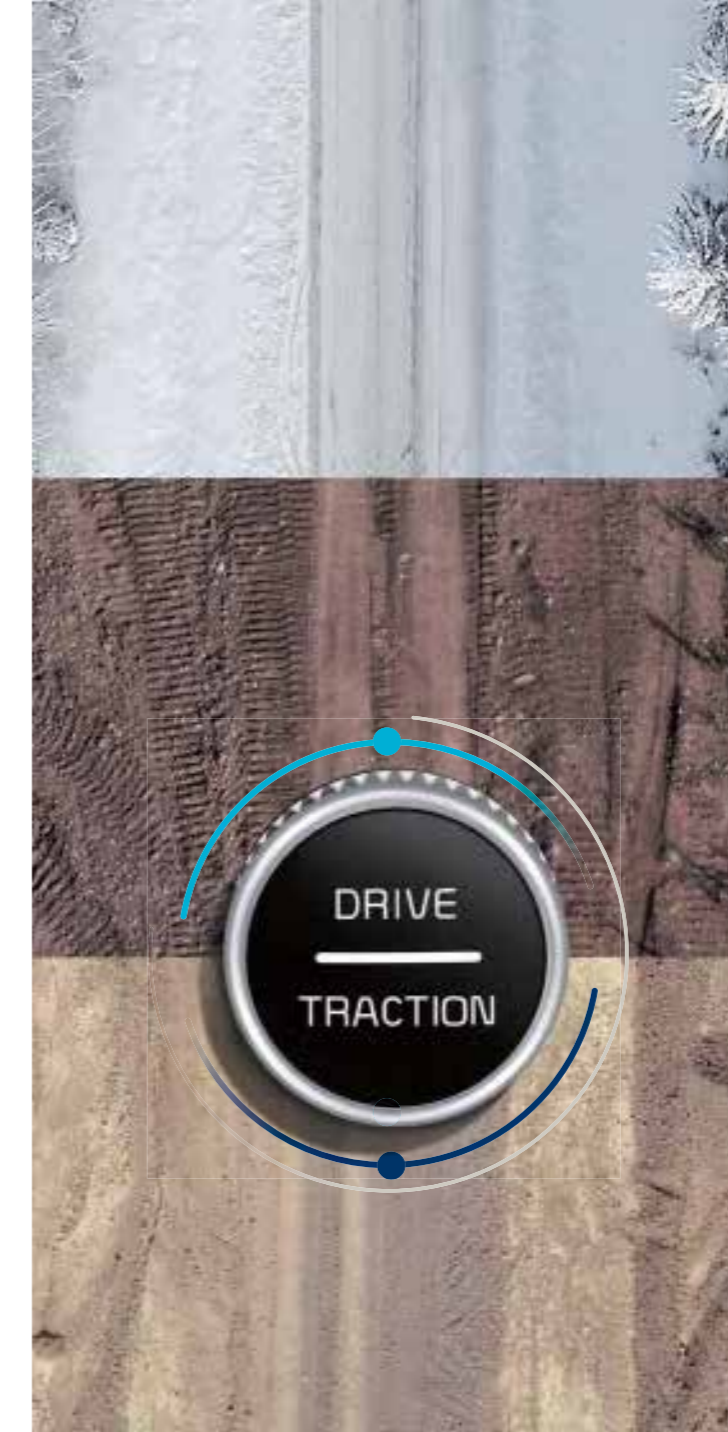

Traction Control Mode

When driving conditions become difficult, TCM steps in to ensure optimal traction. Available on both 2WD and 4WD, TCM automatically selects the right gear and regulates engine torque delivery to each individual wheel so that wheel slip is minimized.



SNOW

SNOW Mode

Rotating the jog wheel controller puts you in Snow Mode and when the Snow Mode icon lights up on the instrument panel then you know you're really ready for some tough winter driving.



MUD

MUD Mode

When you're in Mud Mode, sensors can instantly detect wheel slippage and will automatically redirect torque to the wheel with the most traction so that you can keep moving despite the hazardous driving conditions.



SAND

SAND Mode

Driving on sand poses a unique set of challenges but Kona's smart controller keeps you moving safely ahead. Special algorithms developed for sand driving secure the right gear and ensure each wheel gets the right amount of torque at the right moment to guarantee optimal tire traction.



KONA N Line.

Kona N Line maximizes the sporty factor with an appearance package that really stands out. Both the front and rear ends get the special N Line makeover as do the 18-in diamond cut wheels and side cladding. The cabin abounds with N Line exclusive touches to tell the world that this is no ordinary Kona. Meatier brakes and a sports-tuned suspension enhance ride, handling and stopping performance.





N Line steering wheel
N Line gear shifter knob (7-speed DCT)



N Line sports bucket seats



KONA Hybrid.

Kona's advanced hybrid technologies do more than just reduce emissions, they also help promote a quieter, smoother ride. With the nearly silent running electric motor providing powerful assistance, the 1.6 GDi engine doesn't have to work as hard. This results in a noticeable reduction of noise, vibration and harshness. In the simplest terms, Kona's hybrid technologies will leave you smiling.



10.25" infotainment system
18" Alloy wheel



Best-in-class fuel economy

3.9 l/100 km

based on 16" tires

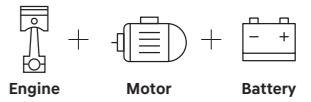

Hyundai SmartSense

Smart Cruise Control with Stop & Go

You set the speed and SCC maintains it while keeping you a safe distance away from the vehicle ahead without requiring application of the accelerator or brake pedal.

Forward Collision-Avoidance Assist (FCA)

If there's danger of a collision with a car or a pedestrian, FCA's front camera gives you an early warning and, if necessary, FCA automatically applies the brakes to prevent the collision.



Lane Keeping Assist (LKA) / Lane Following Assist (LFA)

LKA/LFA keep you safely centered within the lane using its front view camera to monitor lane markers. On detecting an unintentional lane departure, a warning is triggered and, if necessary, LKA will automatically provide corrective steering input to keep you within the lane.



Blind-Spot Collision-Avoidance Assist (BCA)

BCA uses radar to monitor both of your blind spots. If a vehicle is detected in the blind spot while the turn signal is flashing, BCA will automatically apply left or right side front braking before your attempted lane change thus helping you avert an unsafe lane change and a potential collision.



Parking Distance Warning (PDW)

Proximity sensors in the front and rear bumpers warn you if you're too close so you can avoid scratches and park safer.

Safe Exit Assist (SEA)

SEA blocks attempts to disengage the child safety lock and prevents the rear door from opening when it is unsafe to do so.



Features

KONA Wheels



16" Steel Wheel & Wheel Cover 16" Alloy wheel 17" Alloy wheel 18" Alloy wheel

KONA Hybrid Wheels



16" Alloy wheel 18" Alloy wheel

KONA N Line Wheel



18" Alloy wheel



Cascading grille Projection headlamps LED headlamps Rear combination lamps (bulb type) LED rear combination lamps



8" touch screen display 4.2" Supervision cluster Manual air conditioning system Full auto air conditioning system Ambient lighting cup holders



Rear USB port with tray Head-up display (HUD) N Line specific LED headlamps N Line specific front bumper with grille N Line specific rear bumper with twin tip muffler



Heated seats Ventilated seats N Line specific side emblem N Line specific side sill moulding N Line red-color accent AC vents

Interior colors



Black one-tone interior



Khaki two-tone interior



N Line Black one-tone interior (Red point)

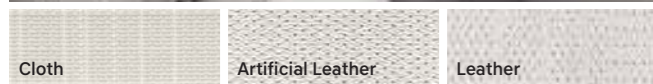

Light Beige two-tone interior



Light Beige two-tone interior

Exterior colors

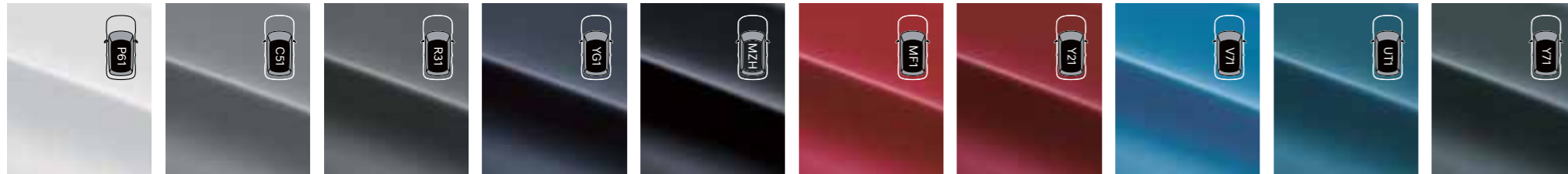

P6W Chalk White **C5G** Cyber Grey **R3G** Galactic Gray **YG7** Dark Knight **MZH** Phantom Black **MFR** Ignite Flame **Y2R** Pulse Red **V7U** Surfy Blue **UTK** Dive in Jeju **Y7H** Misty Jungle

Specifications

Type	KONA		KONA & KONA N Line	KONA Hybrid	
	Smartstream G1.0 T-GDi	Smartstream G2.0 Atkinson	Smartstream G1.6 T-GDi	1.6 GDi	Electric motor
Engine type	3-Cylinder DOHC	4-Cylinder DOHC	4-Cylinder DOHC	4-Cylinder	Motor Type Permanent Magnet Synchronous Motor(PMSM)
Displacement (cc)	998	1,999	1,598	1,580	Max. Power (kW)
Max. Power (ps / rpm)	120 / 6,000	149 / 6,200	198 / 6,000	105 / 5,700	Max. Power (ps)
Max. Torque (kg-m / rpm)	17.5 / 1,500-4,000	18.3 / 4,500	27.0 / 1,600-4,500	15.0 / 4,000	Max. torque (Nm)
Brakes					
Front	Ventilated discs				
Rear	Solid discs				
Suspension					
Front	MacPherson strut				
Rear	Coupled T-Beam Axle (2WD)	Coupled T-Beam Axle (2WD), Multi-link Type (4WD)		Multi-link Type (2WD)	
Tire					
	205/60R16, 215/55R17, 235/45R18		235/45R18	205/60R16, 225/45R18	
Dimensions					
Head room (mm) Front (w / Sunroof) / Rear	1,005 (965) / 961				
Leg room (mm) Front / Rear	1,054 / 893				
Shoulder room (mm) Front / Rear	1,409 / 1,385				

- The above values are results from internal testing and are subject to change after validation.
- Some of the equipment illustrated or described in this catalog may not be supplied as standard equipment and may be available at extra cost.
- Hyundai Motor Company reserves the right to change specifications and equipment without prior notice.
- The color plates shown may vary slightly from the actual colors due to the limitations of the printing process.
- Please consult your dealer for full information and availability on colors and trims.



Wheel tread* 1,559 (1,565)¹
Overall width 1,800



Wheel base 2,600
Overall length 4,205 (4,215)²

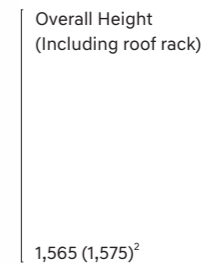

Overall Height (Including roof rack) 1,565 (1,575)²



Wheel tread* 1,568 (1,577)¹

Unit : mm
1 : KONA Hybrid / 2 : KONA N Line

* KONA : * Wheel tread • 16" Alloy wheel (Front / Rear) : 1,575 / 1,584 • 17" Alloy wheel (Front / Rear) : 1,563 / 1,572 • KONA Hybrid: * Wheel tread • 16" Alloy wheel (Front / Rear) : 1,576 / 1,589

Dealer stamp